

# Single Unit Rapid Charger

## PROFESSIONAL TWO-WAY RADIO CHARGER

Model: CHU1

### Intended Use

This universal rapid charger can charge a wide range of two-way radio rechargeable batteries. The charger works with the following:

- A. Lithium-ion, Lithium Polymer, Ni-CD, Ni-MH batteries
- B. Battery capacities between 700mAh and 4000mAh.

### Caution

1. Do not make any modifications to the equipment.
2. Do not replace the battery adapter or the power adapter with similar parts. This can cause damage to the charge unit or to the rechargeable batteries, and will void your warranty.
3. Never attempt to charge alkaline or dry cell batteries. They may burst causing damage and personal injury.
4. Never let metal, wire, or other electrical conductors touch any internal part of the charger.
5. Make sure battery and charger contacts are always clean; otherwise batteries may not fully charge.
6. Use indoors only. Never expose the charger to rain, snow or any liquid.
7. Never incinerate used batteries as it may cause an explosion.
8. Keep the charger away from television sets or radios to prevent interference.
9. When charging Li-ion battery, your outlet must have a protection circuit.
10. Avoid overcharging – Radios/batteries must be physically removed from the charger to stop charging. Batteries should not be left in the charger for more than 15 hours after the LED indicator has turned green.
11. If your batteries have little to no capacity even after being fully charged, completely discharge them and then fully charge them again. If they have very little charge or do not retain a charge, please purchase a new battery.

### Charger Description

1. Power supply adapter
2. 110-240V power supply
3. Charging base. (LED indicator in front.)

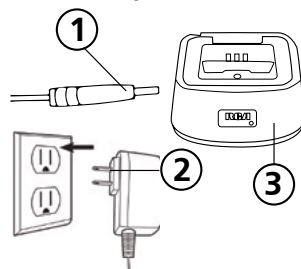

### Charging Procedure

1. Connect the adapter (1) to the charger jack on the rear of the charging base (3).
2. Plug the power supply (2) into an AC outlet.
3. The LED in the front of the base will be orange for a few seconds as the unit runs a self-diagnosis.

- The LED will go dark when the unit is ready.
4. Slide a battery or radio into the charger. Be sure radio is turned off before insertion into charger
  5. The LED indicator will be orange during battery diagnostics, which may last from a few seconds to a few minutes.
  6. The LED indicator will be solid red during charging.
  7. The LED indicator will begin blinking green when charged capacity is over 90%.
  8. The LED indicator will be a steady green when charging is completed.
  9. You may remove the radio and/or battery when the LED indicator is steady or blinking green.

### Notes:

When the LED flashes red, a fault condition exists. There are three different flash patterns, each indicating a specific type of issue. The flash patterns and fault conditions are as follows:

**One Flash** - Indicates charging complete, but battery is under charged. Battery voltage is below minimum level required. This warning happens after charging is complete.

**Two Flashes** - Indicates battery contact is "open" and current is not passing through the (+) and (-) contacts on the battery. This warning is provided after the initial diagnostic stage is complete. Check charging pod to confirm compatibility with battery or contact your RCA dealer.

**Three Flashes** - Indicates over-current condition caused by battery short circuit. Have the battery checked by an RCA technician. Do not attempt to charge the battery if a short circuit exists.

### IMPORTANT

1. After a charged battery is removed, the LED indicator may remain on for a few seconds. Please wait for the LED to turn off, before putting another battery/radio into the charging slot.
2. Using the charger outside the specified temperature range (59° - 86°F/15° - 30°C) may lead to erratic operation, and batteries can be under-charged.

### CHU1 Specifications

Dimensions: 4.5" x 5.4" x 2.6" (115 x 136 x 66mm)  
 Weight: 9.7 oz. charger only (275g)  
 Operating Temp: 59° - 86°F (15° - 30°C)  
 Storage Temp: 32° - 149°F (0° - 65°C)  
 Adapter Output: 15 - 18V {500mA - 900mA)  
 Approval: FCC Approval

## WARRANTY STATEMENT

RCA Communications Systems warrants each new product it supplies to be free from defects in material and workmanship under normal use and service for the time period listed below, provided that the user has complied with the requirements stated herein.

The warranty period begins on the date of purchase from an Authorized RCA Communications Systems Sales and Service Center. This warranty is offered to the original end user and is not assignable or transferable. RCA Communications Systems is not responsible for any ancillary equipment which is attached to or used in conjunction with RCA Communications Systems products.

RCA Communications Systems offers to the original end user a One (1) Year Limited Warranty on the RCA CHU1 Single Unit Charger. During this period, if the product fails to function under normal use because of manufacturing defect(s) or workmanship, it should be returned to the Authorized RCA Communications Systems Sales and Service Center from which it was purchased. The Sales and Service Center will repair the product to full operating specifications or replace the product with a new product of the same make and model. The user is responsible for all charges incurred in returning the product to the Authorized RCA Communications Systems Sales and Service Center. RCA Communications Systems will be responsible for all charges in returning the product to the end user via standard ground shipping service.

RCA Communications Systems shall have no obligation to repair or replace the product, if there is damage as a result of normal wear and tear or if the damage is caused in whole or in part by catastrophe, fault or negligence of the user, improper or unauthorized alterations or repairs to the product, incorrect wiring, use of the product in a manner for which it was not designed, or by causes external to the product. The warranty does not cover physical or liquid damage, which includes, but is not limited to, liquid damage, deep scratches, bent or broken body or frame, and/or damaged charging or accessory ports. This warranty is void if the product serial number is altered, defaced or removed.

THE EXPRESS WARRANTIES CONTAINED HEREIN ARE IN LIEU OF ALL OTHER WARRANTIES, EITHER EXPRESSED OR IMPLIED OR STATUTORY, INCLUDING, WITHOUT LIMITATION, ANY WARRANTY OF MERCHANTABILITY OR FITNESS FOR A PARTICULAR PURPOSE.

FOR ANY PRODUCT WHICH DOES NOT COMPLY WITH THE WARRANTY SPECIFIED, THE SOLE REMEDY WILL BE REPAIR OR REPLACEMENT. IN NO EVENT WILL RCA COMMUNICATIONS SYSTEMS BE LIABLE TO THE BUYER OR ITS CUSTOMERS FOR ANY DAMAGES, INCLUDING ANY SPECIAL, INCIDENTAL, INDIRECT OR CONSEQUENTIAL DAMAGES, OR THE LOSS OF PROFIT, REVENUE OR DATA ARISING OUT OF THE USE OR THE INABILITY TO USE THE PRODUCT.

RCA Communications Systems endeavors to achieve the accuracy and completeness of this manual, but is not liable for any possible omission and printing mistakes or provides no warranty of accuracy or reliability.

All the reproduction and translation of this manual without authorization is prohibited.

All the above specifications and design are subject to change without notice due to continuous development.

No part of this manual may be copied, reproduced, translated, stored in a retrieval system, distributed, or transmitted in any form or by any means, electronic or mechanical, for any purpose without the expressed, written permission from RCA Communications Systems.

The end-user is solely responsible for obtaining any license or other authorizations required by the Federal Communications Commission (FCC). For further information visit [www.fcc.gov](http://www.fcc.gov) or call 1-888-CALL-FCC (1-888-225-5322).

## Replacing A Charging Pod

The charging pod is made from quality materials and designed to provide years of service when properly used. In most cases, the charging pod will only be replaced when you want to use the charger with a different battery.

Follow these steps to change the charging pod:

1. Obtain a charging pod made specifically for the CHU1. Confirm that the charging pod is compatible with the battery you want to charge.
2. Unplug the power supply from the CHU1.
3. Turn the locking screw on the bottom of the charging pod counter-clockwise several rotations. Lift the charging pod from the charging base.
4. Insert the replacement charging pod into the charging base and secure with the locking screw. Do not over tighten the screw.
5. Inspect the charging contacts to ensure they are clean and unobstructed.
6. Connect the power supply to the CHU1. You are now ready to charge a battery compatible with the charging pod.

---

For Sales, Warranty and Customer Support please contact:  
**Discount Two-Way Radio Corporation – North American Distributor**  
1430 240th Street  
Harbor City, CA 90710  
Phone: 310-224-5100 / Fax: 310-224-5101  
[www.DiscountTwo-WayRadio.com](http://www.DiscountTwo-WayRadio.com)

---



[www.RCACommunicationsSystems.com](http://www.RCACommunicationsSystems.com)

© 2015 RCA Communications Systems. All rights reserved.